

Haier

Top Mount fridge-freezer
Instruction for use

AFD630IX

AFL628CX/CW

CFL629CW/CX

Table of Contents

Dear Customer

Our sincere thanks for having chosen this quality product, designed and engineered to meet the requirements of modern-day living. This appliance will provide many years of trouble-free service.

This user manual covers a number of different appliances. Some slight differences may therefore apply to some models.

Before use

Key features	1
Description	2-3
Safety precautions	4-6
Placing and environment	7
Preparation prior to use	8-9

Use instructions

Function	10-14
Fridge compartment	15-16
Fridge storage precautions	17
Tips on food storage in the fridge	18
Freezer storage precautions	19
Icemaker use instructions	20

Maintenance

Defrosting and cleaning	21
Stopping use	22
Troubleshooting	23-25

- Please read this Operation Manual carefully before using the appliance.
- Keep this Manual for future reference.
- Please check the appliance for the model, color and door pattern.

Key Features

- ◆ Automatic icemaker (only on some models).
- ◆ Freezer drawers - this facilitates easy access to food item,ensuring energy saving and convenience (only on some models).
- ◆ Slide in half shelf - a full length shelf that slides to half length to allow storage of taller items below.
- ◆ Innovative low-energy lighting system - ensures greater visibility.
- ◆ Foldaway wine holder.
- ◆ Large crisper with humidity control adjustment.
- ◆ Holiday function, energy-saving holiday mode.
- ◆ Power ON/OFF function on the display panel (only on some models).
- ◆ Fridge Storage compartment can be turned off when not required.
- ◆ Intelligent alarm function - automatic alarm at high temperature, electrical malfunction or door open.
- ◆ Touch keys (only on some models).
- ◆ Deodoriser (only on some models).
- ◆ Fresh food drawer.

Description

Models: AFD630IX/AFL628CX/AFL628CW

Fridge storage compartment

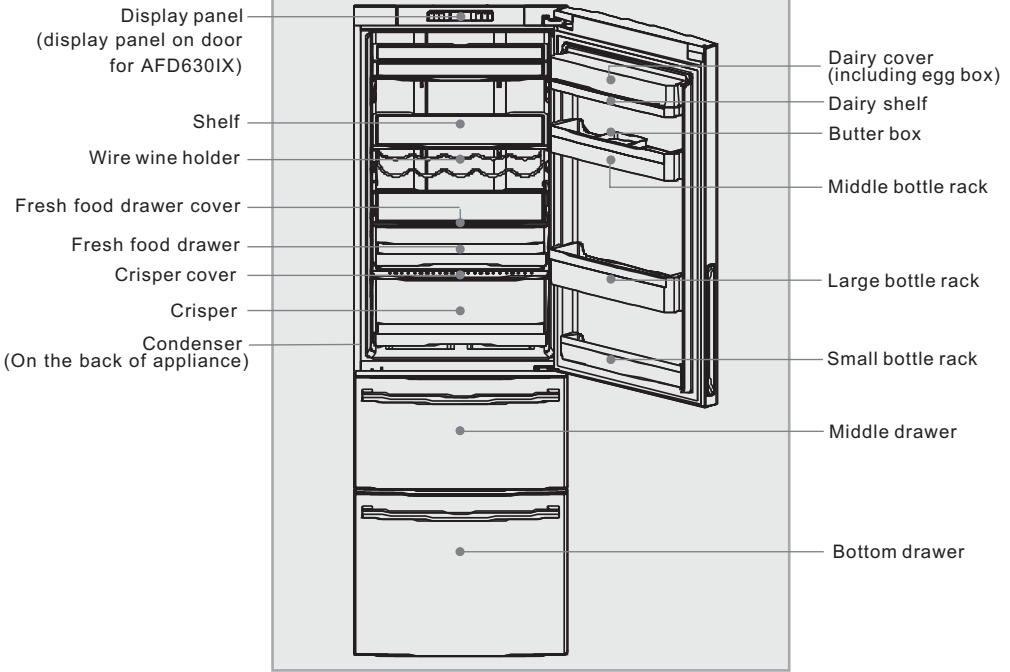

Freezer storage compartment

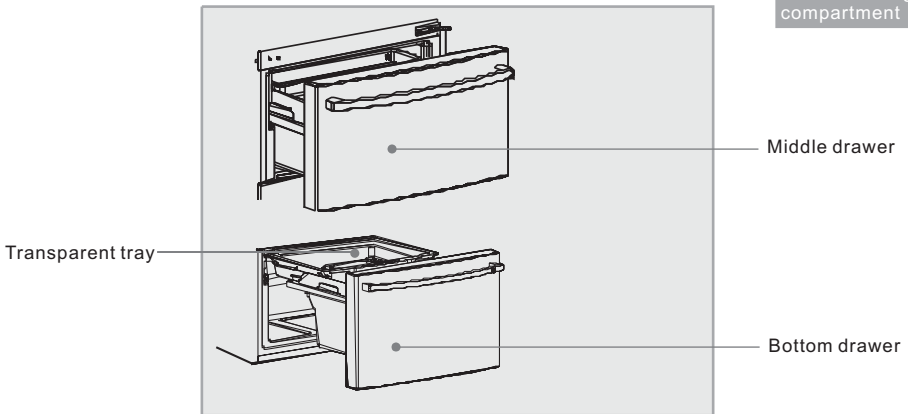

Note

The accessories shown are for several models. There may be slight differences between them and the ones in your refrigerator.

Descriptions

Models: CFL629CW/CFL629CX

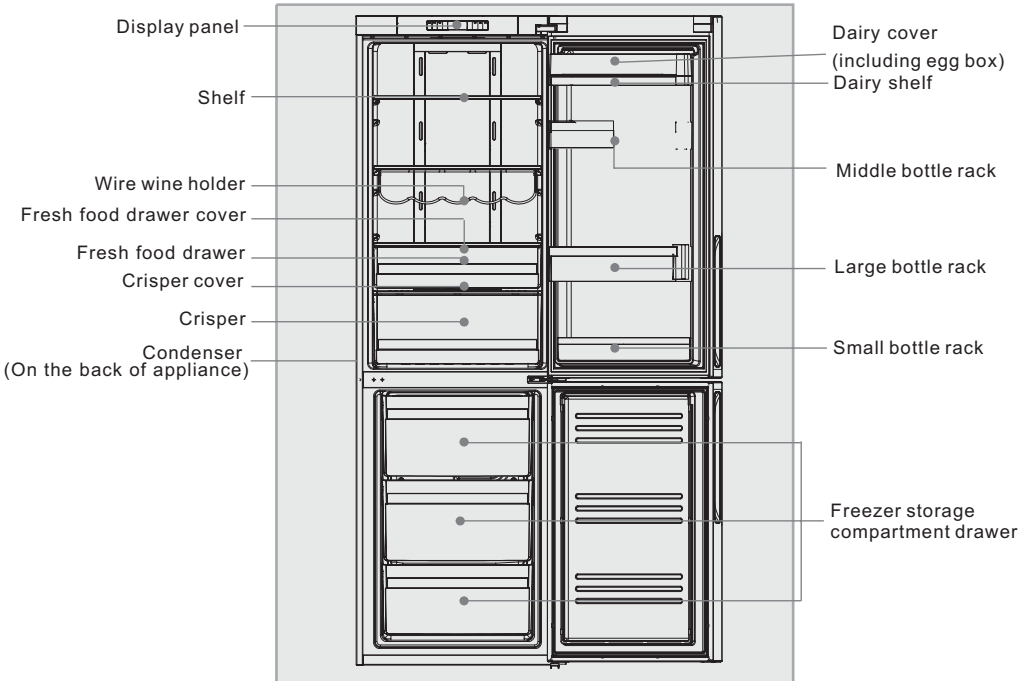

Note

The accessories shown are for several models. There may be slight differences between them and the ones in your refrigerator.

Safety precautions

The refrigerator is operated through a 220-240VAC/50Hz power supply. Abnormal voltage fluctuation may cause the refrigerator to fail, damage the temperature control or compressor, or there may be an abnormal noise when the compressor is operating.

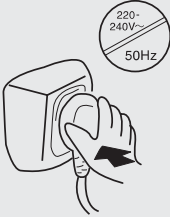

A dedicated power socket with reliable grounding must be used for this refrigerator. The refrigerator's power cable is fitted with 3-pin (grounding) plug that fits a standard 3-pin (grounding) socket. Never cut off or remove the third pin (grounding). After the refrigerator is installed, the plug should be accessible.

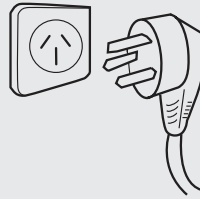

Care for the power cord

- Hold the plug, not the cord, when unplugging the refrigerator.
- Ensure that the power cord is not constrained by the refrigerator.
- Do not step on the power cord.
- Take care not to roll over the power cord or damage it when moving the refrigerator away from the wall.

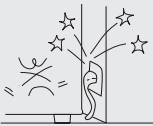

Damaged power cord

- When the power cord is damaged or the plug is worn, turn off the refrigerator and consult an authorized service agent for replacement.

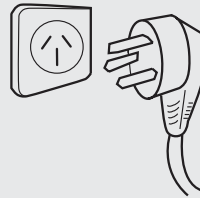

If coal gas or other inflammable gas is leaking in the vicinity of the refrigerator

- Turn off the valve of the leaking gas;
- Open the doors and windows;
- Do not unplug or plug the power cords of the refrigerator or any other appliance.



Unplug the refrigerator for the following reasons:

- Cleaning or maintenance;
- Lamp replacement



Safety precautions

Never store inflammables, explosives or corrosive materials in the refrigerator.



Do not store medicines, bacteria or chemical agents in the refrigerator. This refrigerator is a household appliance. It is not recommended to store materials that require precise temperatures.

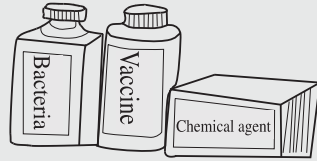

Do not store or use gasoline or other inflammable materials in the vicinity of the refrigerator to avoid a fire.



Do not place unstable articles (heavy objects, containers filled with water) on the top of the refrigerator, to avoid personal injury caused by falling or electric shock caused by contact with water.

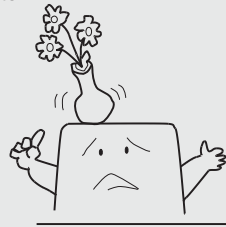

Do not swing from the bottle racks on the door. The door may be pulled out of alignment, the bottle rack may be pulled away, or the refrigerator may topple. Do not step on the freezer storage compartment door or cabinet when putting in or taking out food.



Do not touch the inside surface of the freezer storage compartment when in operation, especially with wet hands, as your hands may freeze onto the surface.



Safety precautions

Hold the door handle when opening and closing the door. Make sure fingers or other objects are not caught when closing doors/drawer(s). Always keep children away when a door is opened or closed.



To ensure the refrigerator's electrical insulation, do not spray/flush the refrigerator with water when cleaning, nor place the refrigerator in a damp area or a location where it may be splashed with water.



Do not dismantle or modify the unit, contact a Customer Care representative to arrange service. Unauthorised repairs to the refrigeration system are strictly prohibited. Any vigorous movement of the appliance may damage the cooling pipes. Property loss or personal injury may result. Repair must be personal carried out by a registered Service Technician or Service Agent.



Never store bottled beer or beverages in the freezer as these will burst during freezing.



Unplug the refrigerator in the event of a power interruption before cleaning. Allow at least 5 minutes before restarting the refrigerator, as frequent start-ups can damage the compressor.

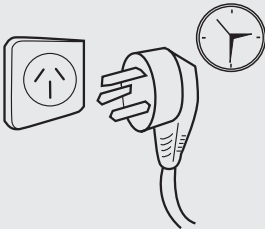

Arrange safe disposal of the old appliance.

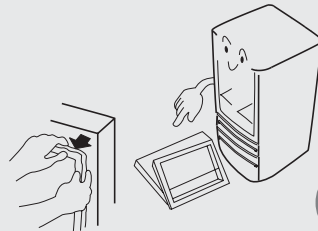

Installation of your refrigerator

The refrigerator should be placed on a flat and solid surface. If the refrigerator is placed on a pedestal or plinth, flat, strong and fire-resistant materials must be used. Never use the foam packing material for a pedestal. If the refrigerator is unbalanced, you can lengthen or shorten the adjustable feet of the refrigerator by turning them clockwise or counter clockwise.

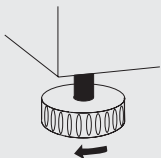

Never place the refrigerator in a damp area or a location where it may be splashed with water. Clean and dry any water splashes and stains with a soft cloth.

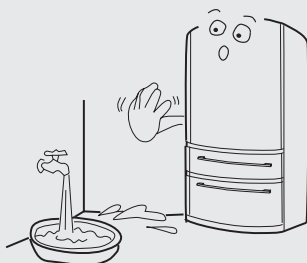

The direction shown is clockwise



The refrigerator should be placed in a well-ventilated place. A space of at least 20cm above and 10cm around the refrigerator is recommended.

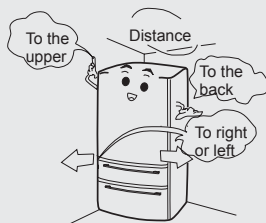

Do not overload the freezer to avoid damage to the compressor or food falling out. It is recommended not to exceed the load line of the drawers. The total weight of the food should not exceed 30kg. To prevent the food from falling out, do not pull open the freezer drawer too quickly or on an angle.

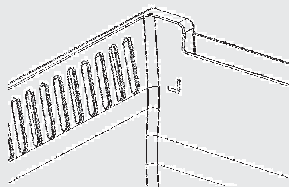

Warning: Keep ventilation openings in the appliance enclosure or in the built-in structure, clear of obstruction.

Warning: Do not use mechanical devices or other means to accelerate the process, other than those recommended by the manufacturer.

Warning: Do not damage the refrigerant circuit.

Warning: Do not use electrical appliances inside the food storage compartments of the appliance, unless they are of the type recommended by the manufacturer.

Warning: This appliance is not intended for use by persons (including children) with reduced physical, sensory or mental capabilities, or lack of experience and knowledge, unless they have been given supervision or instruction concerning use of the appliance by a person responsible for their safety.

Warning: Children should be supervised to ensure that they do not play with the appliance.

Preparation for first use

- ① Remove all packaging including the foam base and the adhesive tape accessories inside the fridge and freezer compartments.

- ② Check accompanying accessories and documents items inside the box against the Packing List.



- ③ Install the handles (AFD630IX/AFL628CX/AFL628CW). Take out the two handles from the accessory box and place them in the handle seats respectively as shown in the figure. Secure the handles on the with the supplied(4) screws. Insert the screw on the underside of the handle.

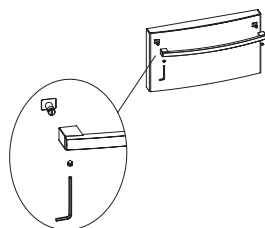

- ④ Move the refrigerator into a proper location. (See section "Placing and environment")

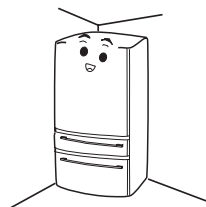

- ⑤ It is advisable to clean the cabinet before use. Please clean the inside and outside of the refrigerator with water before putting any food in it.



- ⑥ Standing before Power Up. After the appliance has been leveled and cleaned, allow gases to settle for at least 6 hours before switching it on, to ensure its normal running.

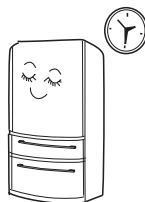

- ⑦ Fridge door reversal (AFD630IX, AFL628CX/CW only). The fridge door hinging can be reverse for these models only. Please contact an Authorized Service Agent.

Preparation for first use

① Connection to power supply

When the refrigerator is connected to the power supply, the fridge temperature and freezer temperature are automatically set to 5°C and -18°C respectively.

② Operation modes of the refrigerator

Manual adjustment mode: set temperature by pressing the temperature setup key (see "Function description" on the following pages).

③ Loading the refrigerator with food

Load the refrigerator after it has been operating for a period and the inside has chilled to desired temperature.



Some time will be required for the refrigerator to reach the set temperature when the setting is changed. The length of this period depends on the difference between the existing and set temperatures, ambient temperature, door opening frequency and the amount of food in storage.

Function

1 Models: AFL628CX/AFL628CW/CFL629CX/CFL629CW

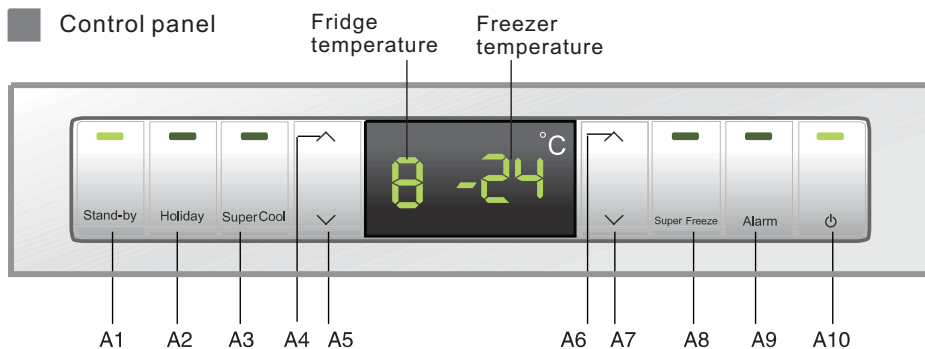

- A1 Switch on/off the fridge compartment
- A2 Holiday function
- A3 Super cool
- A4 Fridge temperature up
- A5 Fridge temperature down

- A6 Freezer temperature up
- A7 Freezer temperature down
- A8 Super freeze
- A9 Over-temperature/door open alarm
- A10 Power ON/OFF

Initial powering on

When the refrigerator is powered on for the first time, the power indicator and the fridge storage compartment indicator will light. The fridge and freezer temperatures will be displayed as “- -” due to the high temperature inside the compartments. The buzzer will beep. Press key A9, and the buzzer will be silenced. After the temperature decreases, the displayed temperatures of the fridge and freezer will become the ex-factory settings “5” and “-18” respectively.

Fridge temperature setup

Press key A4 or A5 to set the fridge temperature. The fridge temperature cycles from 2 to 8. The setting is confirmed automatically 5 seconds after the operation is finished or by pressing any other key.

Freezing temperature setup

Press key A6 or A7 to set the freezer temperature. The freezer temperature cycles from -16 to -24°C. It will be confirmed automatically 5 seconds after the operation is finished or by pressing any other key.

Function

Super cooling

Select this function after you have put fresh food in the fridge compartment. Press key A3, to activate this function and the corresponding indicator will illuminate. This function will automatically deactivate when the temperature decreases to the required level. You can also deactivate it by pressing key A3 again.

When the temperature in the refrigerator compartment is too low, the super-cooling function may not work. That is, when you press the “super-cooling” button once, the buzzer will beep once and the indicator will not blink, meaning the temperature in the refrigerator compartment is too low and the super-cooling function doesn't need to be activated.

Super freezing

If you are freezing large quantities of food in the freezer compartment, please switch on super freezing 24 hours before the food is placed in the freezer compartment. Press key A8, the function is activated and the corresponding indicator illuminates. The function will become inactive automatically after 56 hours. You can also deactivate it by pressing key A8 again.

Holiday function

Press key A2, the corresponding indicator will illuminate and the holiday function of the fridge compartment is activated. In Holiday mode the refrigerator compartment will operate at a relatively high temperature saving energy and at the same time, avoiding the development of mould and bad odor. The fridge temperature will be displayed as “- -” (Please remove the perishable food in the refrigerator and close the door before activating this function). Press A2 again, and the corresponding indicator goes off and the refrigerator reverts to normal operation.

Display control

The display screen will turn off automatically 1 minute after an operation is finished. It can be lit up by opening the door or pressing any key. (Alarm does not light up the display screen)

Door open alarm

When the refrigerator door is open for more than 3 minutes, the alarm indicator will flash and the buzzer will sound 3 beeps every 30 seconds. The buzzer can be silenced by closing the door or pressing key A9.

High temperature alarm in the freezer

When the temperature in the freezer storage compartment rises to a certain value, the alarm indicator will illuminate solid and the buzzer will sound 1 beep every second. The buzzer can be silenced when the temperature in the freezer storage compartment drops to a specified level or key A9 is pressed.

Turning off the fridge compartment

Press and hold key A1 for 3 seconds, and the corresponding indicator will turn off and the fridge compartment will be turned off while the freezer compartment operates normally. The fridge temperature indication icon will also go off. Press and hold key A1 for 3 seconds again, the fridge compartment will be turned on, and the fridge temperature indication icon will light up.

Function

Turning off the refrigerator and freezer compartment function

Press and hold key A10 for 3 seconds, the display panel will go off and the refrigerator and freezer will stop operating. Press and hold key A10 for 3 seconds again, the display panel will light up, and the refrigerator will start operating normally.

This function is not equivalent to turning off the appliance because the PC board continues to operate.

Fault indication

When E or F is displayed due to a fault, the refrigerator will still refrigerate. Please contact an Authorized Service Centre as soon as possible.

2 Model: AFD630IX

Control panel

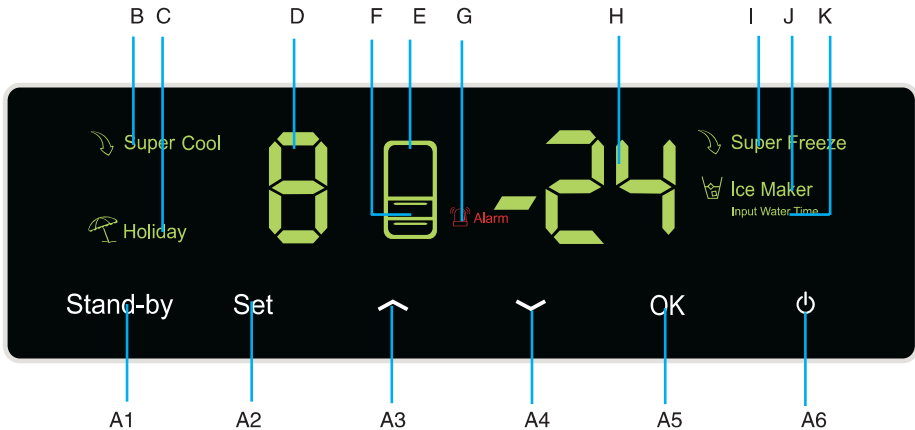

A1 Switch on/off the fridge compartment

A2 Menu key

A3 Temperature up

A4 Temperature down

A5 Confirmation key

A6 Power ON/OFF

B Super cooling icon

C Holiday function icon

D Fridge temperature display

E Fridge compartment indicating icon

F Freezer compartment indicating icon

G Alarm icon

H Freezer temperature display

I Super freezing icon

J Icemaker icon (only on models with an icemaker)

K Water input time adjustment icon (only on models with an icemaker)

Initial powering on

When the refrigerator is powered on for the first time, icon G will light. The fridge and freezer temperatures will be displayed as "--" due to high temperature inside the compartment. The buzzer will beep. Press key A5, the buzzer will be silenced and icon G will remain lit. After the temperature decreases, and the displayed temperatures of the fridge and the freezer icon G will turn off compartments will become the ex-factory settings "5" and "-18" respectively. The brightness of D, E, & H icon will decrease to half automatically.

Function

Fridge temperature setup

Press key A2 until icon D flashes. Then, press key A3 or A4 to set the temperature. The refrigerating temperature cycles from 2 to 8. After you have set it to the desired value, press key A5 to confirm.

Note: Flashing of icon D is accompanied by flashing of icon E

Freezer temperature setup

Press key A2 until icon H flashes. Then, press key A3 or A4 to set the temperature. The freezer temperature cycles from -16 to -24. After you've set it to the desired value, press key A5 to confirm.

Note: Flashing of icon H is accompanied by flashing of icon F

Super cooling

Press key A2 until icon B flashes. Then, press key A5 to confirm the super cooling function. Icon B will illuminate. You can deactivate the super cooling function with the same operation. When the temperature in the refrigerator compartment is too low, the super-cooling function may not work. That is, when you press the "super-cooling" button once, the buzzer will beep once and the indicator will not blink, meaning the temperature in the refrigerator compartment is already low and the super-cooling function doesn't need to be activated.

Holiday function

Press key A2 until icon C flashes. Then, press key A5 to confirm the holiday function. Icon C will illuminate solid. You can deactivate the holiday function with the same operation.

In Holiday mode the refrigerator will operate at a relatively high temperature saving energy and at the same time, avoiding the development of mould and bad odor. (Please remove the perishable food in the refrigerator and close the door before activating this function). Press A2 again, and the corresponding indicator goes off and the refrigerator reverts to normal operation.

Super freezing

If you are freezing large quantities of food in the freezer compartment, switch on super freeze function 24 hours before the food is placed in the freezer compartment. Press key A2 until icon I flashes. Press key A5 to confirm the super freezing function. Icon I will illuminate solid. You can deactivate the super freezing function with the same operation. The function will become inactive automatically after 56 hours.

Ice making function (only on models with an icemaker)

Press key A2 until icon J flashes. Press key A5 to confirm the ice making function. Icon J will illuminate solid. You can deactivate the ice making function with the same operation.

Note: If the ice machine is not installed, the H icon on the display panel will be displayed as "Er".

Icemaker's water flow time adjustment (only on models with an icemaker)

Press key A2 until icon K flashes. Press key A5 to confirm the icemaker's water flow time adjustment. Icon K will illuminate solid. The water flow time will be indicated with icon H and icon D. For example, if the time is 4.0s, icon H will be 4 and D will be 0. Press key A3 or A4 to set the time in an increment of 0.5s. It cycles from 2s to 7s. After you have set it to the desired value, press key A5 to confirm. Icon K will go off. You can exit the icemaker's water flow time adjustment with the same operation.

Note: this operation can be performed only when the ice making function is selected.

Function

Display control

The display screen will dim 1 minute after an operation is finished. It will recover to normal brightness when you open the door or press any key. (Alarm does not light up the display screen)

Door open

When the fridge compartment door is open for more than 3 minutes, icon G will flash and the buzzer will give out 3 beeps every 30 seconds. If you close the door, the alarm will be silenced and icon G will go off. You can also silence the buzzer by pressing key A5.

High temperature alarm in the freezer

When the temperature in the freezer compartment rises to a certain value, icon G will illuminate and the buzzer will sound 1 beep every second. When the temperature in the freezer compartment drops to a specified level, the alarm will silence and icon G will go off. You can also silence the buzzer by pressing key A5.

Switching off the fridge compartment

Press and hold key A1 for 3 seconds, the fridge compartment will be turned off while the freezer compartment is operating normally. At this time, icon D will go off and icon E will become dim.

Press and hold key A1 for 3 seconds again, the fridge storage compartment will be turned on, icon D and icon E will recover their normal brightness.

Note: if super cooling or holiday function was selected previously, the function will be deactivated and corresponding icon will turn off when the fridge compartment is turned off.

Switching off the refrigerator and freezer compartment

Press and hold key A6 for 3 seconds, the display panel will go off and the refrigerator and freezer will stop operating. Press and hold key A6 for 3 seconds again, the display panel will light up and the refrigerator will start operating normally.

This function is not equivalent to turning off the appliance because the PC board continue to operate.

Error indication

When E or F is displayed due to a fault, the refrigerator can still refrigerate. Please contact an Authorized Service Centre as soon as possible.

Fridge Compartment

Foods that are perishable, or for daily consumption should be stored in the fridge compartment.

Although the average temperature in most areas in the fridge compartment can be regulated between 0°C and 10°C, an extended period of food storage is not recommended. The fridge compartment should only be used for short-term storage.



Adjustable shelf height (only on some models)

The shelf can be relocated to accommodate food size or height. To adjust the height of a shelf, remove it first: uplift its front edge and then pull it out.

To install the shelf, guide both sides of the shelf on the supporting ribs and gently slide it into place.

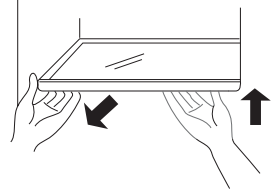

Fruit & Vegetable drawer

The refrigerator has a crisper. You can adjust the humidity according to the requirements of the food to be stored inside.

● Turning the humidity control to the right increases the humidity level, more suitable for foods such as cucumbers, grapes, kiwifruit, persimmons, etc.

● Turning the humidity control to the left enables the crisper to keep in a lower humidity suitable for strawberries, oranges, beans, garlic, watermelon, plums, tomatoes, etc.

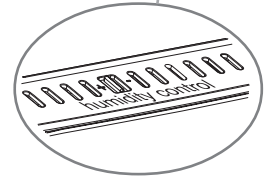
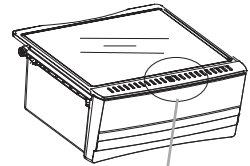

Fresh control drawer

The temperature in this drawer is kept at approx 0°C, however it may vary due to the different ambient temperature or user refrigerator settings. It is suitable for storage of fresh fish, meat and cooked food for 1~2 days.

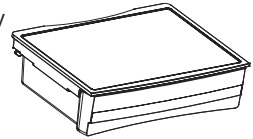

Removal and cleaning of the door bins

To take out a door bin, lift in direction ① and grip both sides and pull it out in direction ②. After cleaning, install it in reverse order, as above.

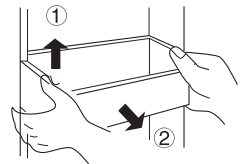

Fridge Compartment

Use of the sliding half shelf

Fig. ① shows the extended state of the sliding shelf used to store small food containers.

Fig. ② shows the retracted state of the sliding shelf which allows for taller food containers below.

To slide the shelf from state ① to state ②, simply push structure A upwards, and push structure B inward in the direction of the arrow shown in the figure so it slides under structure A.

To extend the shelf from state ② to state ①, push structure A upwards, and pull structure B in the direction of the arrow shown in the figure.

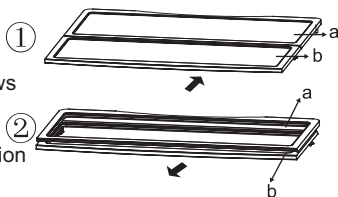

Use of the wire wine holder

Fig. ① shows the folded state of the wire wine holder. In this state, other large item can be stored.

Fig. ② shows the extended state of the wire wine holder. In this state it can hold several wine bottles.

To extend it from state ① to state ②, simply pull the wire down.

The maximum total load of the bottle holder is 10 kg.

To fold it from state ② to state ①, simply push the wire rack up.

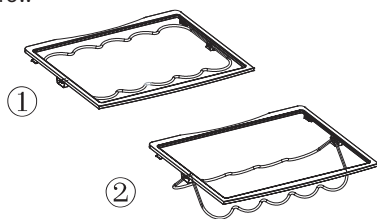

Note

Make sure the ends of the shelves are on the same level. Otherwise the shelf or the food may fall or spill.

Recommended storage areas for various foods

As cold air circulates inside the refrigerator, there are temperature differences inside the fridge compartment. Different foods should be placed in specified areas according to their properties.

- ① Eggs, butter, cheese(Dairy) etc.
- ② Drinks, canned food etc.
- ③ Seasonings and pickled food
- ④ Beverages, canned food, cake, etc.
- ⑤ Wine, champagne, etc.
- ⑥ Milk, cheese, etc
- ⑦ Cooked meat, fresh fish and raw meat, etc.
- ⑧ Fruit, vegetables, salad, etc.

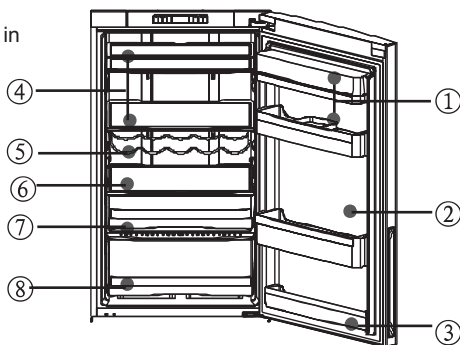

Lamp in the fridge compartment and its replacement

Do not attempt to repair or replace the lamp. If a replacement lamp is required, please contact Customer Care or an Authorized Service Centre.

Fridge storage precautions

Hot foods must be cooled to room temperature before storing in the refrigerator.

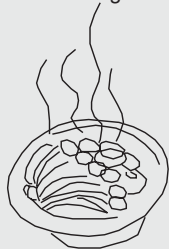

Clean and dry food or bottles/containers, before placing in the refrigerator.



Food to be stored should be properly sealed. This will prevent moisture in the food from evaporating and prevent them from spoiling.



Sorted storage of food. Food to be stored should be sorted according to their category. Food consumed daily should be placed on the front part of the shelves. This can avoid prolonged door opening as well as expiration of the storage period due to the item being forgotten.



Do not store excess quantities of food. Food should be stored with spaces in between them. This allows cold air to flow smoothly and therefore obtain better storage results.

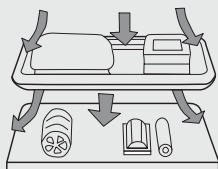

Do not place the food too near to the inner walls. Do not store foods with high moisture content against the inner walls. Otherwise they may freeze to the walls. Place food a little away from the inner walls.



Note

Avoid food (especially oil food) contact with the inner liner directly, as oil can erode the inner liner. It's best to remove any oily residue or wrap whenever it is found.

Tips on food storage in the fridge

Leafy vegetables should be trimmed before storage so as to prevent the nutrition from being absorbed by the leaves, and/or leaves rotting.

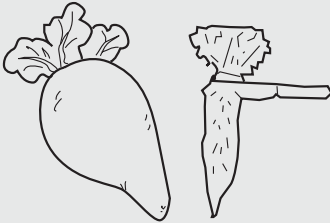

Cover and thaw frozen food in the fridge compartment. In this way you can use the frozen food decrease the temperature in the compartment and save energy.

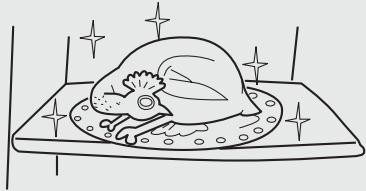

Some vegetables, for example, onion, garlic, ginger, water chestnut, and other similar foods, can be stored for long periods at room temperature. There is no need to store them in the refrigerator.

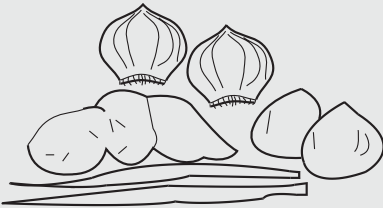

Storing of vegetable marrow, melons, pawpaw, banana and pineapple in the refrigerator can accelerate aging, so it is not recommended to store them in the fridge compartment. However, storing green fruits in the refrigerator for certain periods can promote their maturing.



Freezer storage precautions

Hot food should not be stored in the refrigerator until it has cooled down to room temperature



Food cut into small portions will freeze faster and be easier to defrost and cook. The recommended weight for each portion is less than 2.5kg.

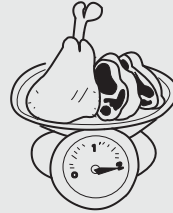

It's better to pack food before putting it in the freezer. The outside of the packing must be dry to avoid bags sticking together. Packing materials should be odor-free, airtight, non-poisonous and nontoxic.

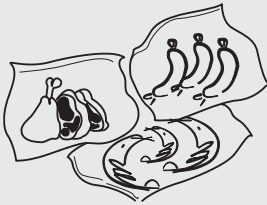

In order to avoid expiration, note the freezing date, time limit and name of the food on the packing.

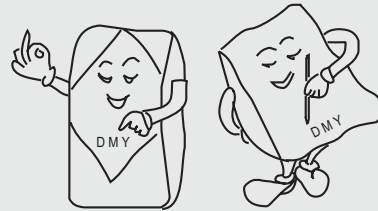

Only take the required amount of food from the freezer. Defrosted food cannot be re-frozen unless it is first cooked.

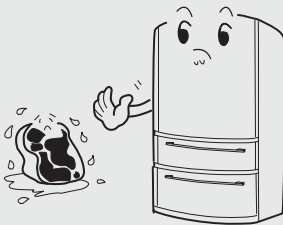

Do not load excessive quantities of fresh food in the freezer. Refer to the cooling capacity of the refrigerator. (See the "Serial plate for technical data".)

Icemaker Installation Instructions

① Before using the icemaker

- Cut the water pipe to desired length while ensuring it is free from excessive bends. Generally the total length should not be more than 5m. A longer pipe may reduce water pressure and, as a result, reduce the water output flow-rate and ice-making capacity;
- The water pipe should be away from any heat sources as it is not heat-resistant;
- The water pipe should be installed and tested by an uthorized Service Agent;
- The icemaker should be connected to a water source of a pressure between 1.5PSI and 7PSI;

② Cleaning the ice cube tray

- Deactivate the ice machine function on the display panel. Take out the icemaker assembly. Turn the icemaker assembly over ice cube tray will be visible underneath.
- Pull the elliptical fastener of the icemaker in direction ①.
- Take out the ice cube tray in direction ②.
- After cleaning, re-install using reverse of direction above. Push the ice machine firmly into place, Close the freezer door, and activate the ice machine function on the display panel.

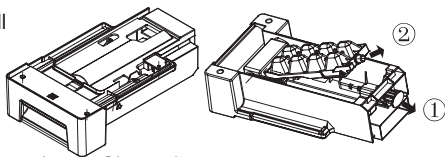

③ Precautions

- Never install the icemaker's water tube in an area with the ambient temperature below 0°C to avoid icing of water supply.
- The icemaker will start ice cube making when the internal temperature reaches or is below -12°C. (If the icemaker is used for the first time or after an extended period of vacation, the first loads of cubed ice should be discarded as there maybe impurities in the water tube).
- After the appliance is installed, the water tube should be placed to prevent it from being crushed.
- Installation of the icemaker can only be carried out by an Authorized Service Agent.
- This icemaker can only be supplied with drinking water.

④ Operating principle of the icemaker

Eight(8) ice cubes are made in every cycle. The ice making capacity depends on ambient temperature, door-opening frequency, water pressure, freezer temperature and other conditions. To ensure that the storage box is fully filled with cubed ice, empty the cubed ice into the drawer frequently.

It is normal that some of the cubes stick to each other.

(This can be improved by decreasing water supply duration).



Note

For a newly installed refrigerator, please let the appliance operate for 24 hours before making ice.

⑤ If this is your first icemaker

Some "cracking" sounds may be heard in the process of ice making, it's normal.

⑥ If you do not use cubed ice frequently

Cubed ice stored for an extended period may become opaque or emit an odor. Please empty the cubed ice storage box regularly and clean it with warm water. Before putting the box back, make sure to cool it down and to dry it. Otherwise cubed ices may stick to the box.

⑦ If you do not want to use the cubed ice storage box for an extended period

Turn the ice maker off by pressing J and then A2 on the panel. Take out all the cubed ice from the storage box and wash the box with warm water. Wipe the box with a dry towel before replacing it into the appliance. Turn off the valve between the water source and the appliance.

⑧ In order to use all of the available freezer storage compartment, the icemaker assembly can be taken out permanently.

Defrosting and Cleaning

■Defrosting the freezer

The freezer defrosts automatically. No manual operation is needed.

■Cleaning

The refrigerator should be cleaned regularly to prevent bad food odours.

- For safety, unplug the power cord before cleaning the refrigerator.
- Clean the refrigerator with a soft cloth or sponge and warm water (a mild detergent can be added).
- Dry water droplets on the refrigerator surfaces with a dry cloth.



■Use of the deodoriser(on some models)

● The service life is from 5 to 6 years. But as the kind and concentration of odours in each refrigerator varies due to different operation condition and environment, we recommend you to set the replacement cycle for 3 years.

● After prolonged use, the deodoriser can be recharged in sunlight for 30 minutes to recover the deodorization effect. To clean, please rinse with slow water flow.



Note

- ① The refrigerator is very heavy. When you are moving for installation of cleaning, take care not to damage the floor. Keep the refrigerator upright during moving. Do not move the refrigerator by rocking it to avoid damage to the floor.
- ② Do not spray or flush the refrigerator with water to avoid impact on its electrical insulation.
- ③ Do not clean with hard brush, wire brush, detergent powder, gasoline, amyl acetate, acetone and similar organic solutions, or acid or alkaline solutions.
- ④ Do not touch cold external surfaces with wet hands; otherwise your skin may stick on the cold iron parts.
- ⑤ When cleaning, do not clean the cold glass shelves with warm water. Otherwise the glass may shatter due to sudden temperature change and cause injury or property loss.

- Always keep the door gasket clean.



Interrupted use

■ Power interruption

Even in summer, food may be stored in the refrigerator for a few hours after a power interruption. If a power interruption occurs, please call the power company to ask about the interruption duration.

● Do not put additional food into the refrigerator during a power interruption and try to open the door as few times as possible.

● If prior notice of a power interruption is given and the interruption duration is over 24hrs, make some ice and put it in a container in the top of the fridge storage compartment.



Note

As the temperature in the refrigerator will rise during a power interruption or other failures, the storage period and edible quality of food will be reduced.

■ Suspended Operation

If the refrigerator will not be used for an extended period, please unplug the power cord, disconnect the water source, and clean it. Please ensure all food is removed from both fridge and freezer compartment. Keep the refrigerator door open to prevent any food odours.



Note

To ensure the service life of the refrigerator, it is recommended that the refrigerator not be turned off unless it is necessary.

■ Before leaving for a vacation

If leaving on an extended vacation, please disconnect the power and water source, remove any food, wait for the frost to melt.

Clean and dry the interior, and keep the door open to prevent bad odours.

If room temperature is expected to drop below 0 °C, please ask a qualified service person to drain the water in the water supply system.

Note: Serious property loss may be caused due to overflow of water if the water pipe or joint breaks.

■ Moving the refrigerator

● Unplug the refrigerator.

● Remove all food.

● Secure the shelves and crisper in the fridge compartment as well as the shelves and other movable parts in the freezer with adhesive tape.

● Close the door and secure with adhesive tape.

● Do not tilt the refrigerator more than 45 degrees (angle to vertical) to avoid damaging the refrigerating system.

● Do not move the refrigerator by its handle to avoid property damage or personal injury.

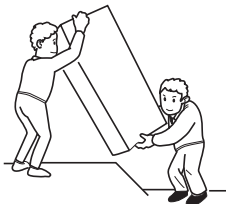

Warning

Never place the refrigerator down horizontally.



Troubleshooting guide

Before calling for service, please read the following troubleshooting guide first. This can save both time and money. The table contains common problems and solutions.

Problems	Causes	Solutions
Refrigerator operation		
The compressor does not work	<ul style="list-style-type: none"> ● The refrigerator is in the defrosting cycle. ● The refrigerator is not plugged into a power outlet. ● The refrigerator is turned OFF. 	<ul style="list-style-type: none"> ● This is normal for an automatic defrosting refrigerator. ● Verify the plug is plugged in the socket firmly. ● Press the "Power" button for 3 seconds or more to restart the refrigerator.
The refrigerator runs frequently or runs for too long	<ul style="list-style-type: none"> ● The temperature is high in the appliance or the room. ● The refrigerator has been powered off for a period of time. ● The automatic icemaker is operating. ● The door is opened frequently or for long periods of time. ● The door of the fridge / freezer is not firmly closed. ● The temperature setting for the freezer compartment is set too low. ● The door gasket of the fridge/freezer compartment is dirty, worn, cracked or mismatched. ● The condenser on the appliance is dirty. 	<ul style="list-style-type: none"> ● In this case, it is normal for the refrigerator to run longer. ● Normally, it takes 8 to 12 hours for the refrigerator to totally cool down. ● Ice-making process makes the refrigerator run longer. ● Warm air enters the refrigerator and causes it to start frequently. Please do not open the door too frequently. ● Ensure the refrigerator is located on a level surface and there is no food or container holding the door open. ● Set the temperature higher until a satisfactory refrigerator temperature is obtained. It takes 24 hours for the refrigerator temperature to become stable. ● Clean or replace the door gasket. A gap in the door gasket can cause a longer running time of the refrigerator. ● Wipe with dry duster.
High temperature in Fridge/Freezer compartment		
High temperature in the freezer/fridge	<ul style="list-style-type: none"> ● The door is opened too frequently or for too long each time. ● Temperature is set too high. ● The door is not closed tightly. ● The freezer temperature is set too high. 	<ul style="list-style-type: none"> ● Warm air will enter the refrigerator whenever the door is opened. Try to open the door less frequently ● Reset the temperature. ● Ensure the refrigerator is located on a level surface and there is no food or container holding the door open. ● Clean the condenser.
High Freezer Temperature	<ul style="list-style-type: none"> ● The freezer temperature is set too high. 	<ul style="list-style-type: none"> ● Set the freezer temperature lower. It takes 24 hours for the temperature of the refrigerator to become stable.

Troubleshooting

Problems	Causes	Solutions
High temperature		
High fridge temperature	<ul style="list-style-type: none"> ● The fridge temperature is set too high. 	<ul style="list-style-type: none"> ● Set the fridge temperature lower. It takes 24 hours for the temperature of the refrigerator to become stable.
Water/moisture/frost in the refrigerator		
Moisture accumulates on the refrigerator inner walls	<ul style="list-style-type: none"> ● Hot and moist climate. ● The door is not closed tightly. ● The door is opened too frequently or for too long each time. 	<ul style="list-style-type: none"> ● Accumulation of frost and moisture is accelerated in such climate. ● Ensure the refrigerator is located on a level surface and there is no food or container holding the door open. ● Do not open the door too frequently.
Water/moisture/frost on outside surface of the refrigerator		
Moisture accumulates on the refrigerator's outside surface or between two doors	<ul style="list-style-type: none"> ● Damp climate. ● The refrigerator door is not closed tightly. This causes condensation of the cold air in the refrigerator and the warm air outside it. 	<ul style="list-style-type: none"> ● This is normal in a damp climate. The moisture will decrease when the humidity drops. ● Ensure the refrigerator is located on a level surface and there is no food or container holding the door open.
Automatic icemaker		
The icemaker does not make ice	<ul style="list-style-type: none"> ● The icemaker is not turned on ● The water supply valve is not turned on ● The temperature in the freezer is not low enough ● The icemaker is not installed correctly. 	<ul style="list-style-type: none"> ● Turn on the icemaker on the display panel. ● Turn on the water supply valve. ● See "Too high temperature" in troubleshooting section. ● Push the icemaker to its proper place.
Ice-making capacity is insufficient	<ul style="list-style-type: none"> ● The ice-making capacity is less than expected ● The temperature in the freezer is not low enough 	<ul style="list-style-type: none"> ● The icemaker can make approximately 1kg of cubed ice in 24 hours. ● Set the freezer temperature lower.
The icemaker will not stop making ice	<ul style="list-style-type: none"> ● Its ice detection bar is switched on by some object in the freezer storage compartment. 	<ul style="list-style-type: none"> ● Remove the object that is restricting the ice detection bar, free the ice detection bar and remove all frozen ice patches from around the ice detection bar.
The cubed ice tastes bad	<ul style="list-style-type: none"> ● Tainted by odours in the fridge or freezer storage compartment. ● The water supplied to the icemaker is not fresh. ● The cubed ices have been stored for an extended period. 	<ul style="list-style-type: none"> ● Cover all the food tightly. Discard the ice stored for a long period or made in the first loads. ● Add a filter on the water supply pipe. ● Discard the cubed ice stored too long.
Bad odours in the refrigerator		
The inside of the refrigerator is dirty	<ul style="list-style-type: none"> ● The inside of the refrigerator needs cleaning ● Food of strong odour is stored in the refrigerator 	<ul style="list-style-type: none"> ● Clean the inside of the refrigerator. ● Wrap the food tightly.

Troubleshooting

Problems	Causes	Solutions
If you hear the following		
Beeps	<ul style="list-style-type: none"> ● The fridge storage compartment door is open. ● The temperature in the freezer is too high. 	<ul style="list-style-type: none"> ● Close the door or silence the alarm manually. ● The alarm is normal when it is first started due to relatively higher temperature. You can silence the alarm manually.
Abnormal sound	<ul style="list-style-type: none"> ● The refrigerator is not located on a level surface. ● The refrigerator touches some object around it. 	<ul style="list-style-type: none"> ● Adjust the feet to level the refrigerator. ● Remove objects in contact with appliance.
Slight sound similar to that of flowing water	<ul style="list-style-type: none"> ● This is the sound of the refrigerating system 	<ul style="list-style-type: none"> ● No action required.
Heating of cabinet	<ul style="list-style-type: none"> ● The de-condensation and refrigeration systems is working. 	<ul style="list-style-type: none"> ● This prevents condensation and is normal.



Do not dispose of electrical appliances in unsorted municipal waste, use separate collection facilities. Contact your local council for information regarding the collection systems available. If electrical appliances are disposed of in landfills or dumps, hazardous substances can leak into the groundwater and get into the food chain, damaging your health and well-being.